



STROM
L I V I N G

Ph: (916) 638-2722 / Fax: (916) 638-2725

Installation Information

Item #P0144

**Warranted only if installed by a qualified licensed plumber.
Use Teflon paste or tape on all threaded connections.**

- 1. Thread the included vacuum breaker onto the water outlet.**
- 2. Thread the hex end of the hose onto the vacuum breaker and thread the tapered end of the hose onto the hand held shower.**
- 3. Turn on the water to check for leaks.
If leaks occur, carefully tighten using an adjustable wrench (wrap with duct tape to protect the finish of the product).**

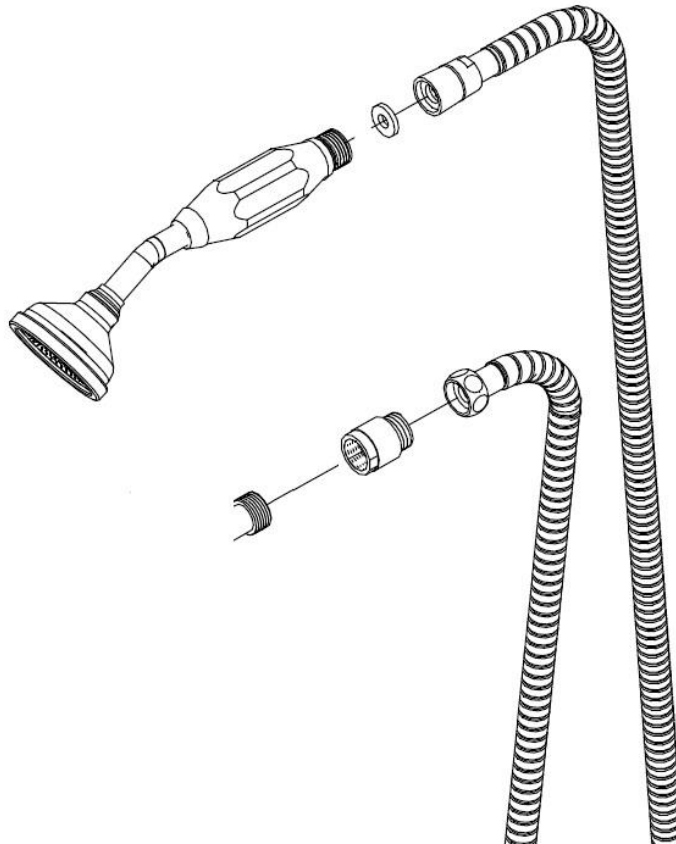

FAX 916-638-2725